

Formulate Essential Ring Hanging Structures

ESS-RNG

Formulate™ Essential Ring tension fabric hanging structures are available in numerous sizes. The economy aluminum tube frame features bungee cords for easy connections, hanging cables and a zippered pillowcase graphic. All sizes come with a carry bag and feature a one year limited hardware warranty.



Single sided graphic

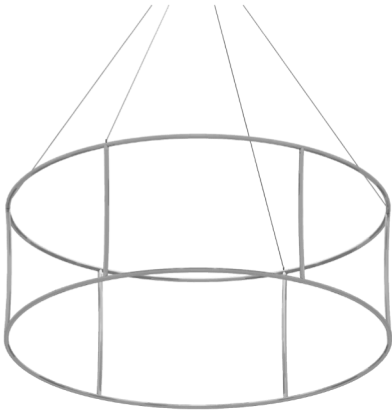

Frame



Double sided graphic



Graphic with printed bottom

features and benefits:

- Economy aluminum tube frame features bungee cords for easy connections
- Quick set up
- Graphics available double or single sided
- Kit Includes: one frame, pillowcase zipper fabric graphic (sold separately), hanging cables and carry bag
- One year limited hardware warranty against manufacturer defects

dimensions:

Hardware	Shipping
	<p>Shipping dimensions:</p> <p>0802: 54"l x 16"w x 15"h 1372mm(l) x 406mm(w) x 381mm(h)</p>
Graphics	<p>0803: 54"l x 16"w x 15"h 1372mm(l) x 406mm(l) x 381mm(h)</p> <p>0804: 54"l x 16"w x 15"h 1372mm(l) x 406mm(w) x 381mm(h)</p>
Graphic Material: 5 oz. Soft Knit Dye-sublimated zipper pillowcase fabric	<p>1002: 52"l x 16"w x 15"h 1321mm(l) x 406mm(w) x 381mm(h)</p> <p>1003: 52"l x 16"w x 15"h 1321mm(l) x 406mm(w) x 381mm(h)</p> <p>1004: 52"l x 16"w x 15"h 1321mm(l) x 406mm(l) x 381mm(h)</p> <p>1202: 62"l x 16"w x 15"h 1575mm(l) x 406mm(w) x 381mm(h)</p> <p>1203: 62"l x 16"w x 15"h 1575mm(l) x 406mm(w) x 381mm(h)</p> <p>1204: 62"l x 16"w x 15"h 1575mm(l) x 406mm(w) x 381mm(h)</p>

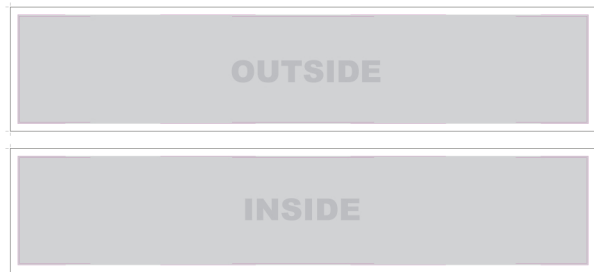
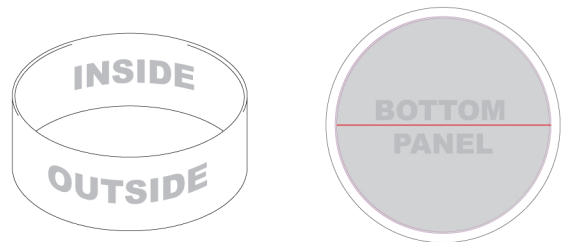

Approximate shipping weight (includes hardware and carry bag only):

- 0802:** 25 lbs / 11.3 kgs
- 0803:** 27 lbs / 12.2 kgs
- 0804:** 29 lbs / 13.2 kgs
- 1002:** 31 lbs / 14.1 kgs
- 1003:** 33 lbs / 15 kgs
- 1004:** 35 lbs / 15.9 kgs
- 1202:** 35 lbs / 15.9 kgs
- 1203:** 37 lbs / 16.8 kgs
- 1204:** 39 lbs / 17.7 kgs

We are continually improving and modifying our product range and reserve the right to vary the specifications without prior notice. All dimensions and weights quoted are approximate and we accept no responsibility for variance. E&OE. See Graphic Templates for graphic bleed specifications.

RNG-8' WIDTH				
HEIGHT	HARDWARE CODE	SINGLE-SIDED GRAPHIC CODE	DOUBLE-SIDED GRAPHIC CODE	BOTTOM ZIP-IN PANEL (PRINTED) CODE
2'	RNG-0802	RNG-0802-G	RNG-0802-GDBL	RNG-0802-GPBP
3'	RNG-0803	RNG-0803-G	RNG-0803-GDBL	RNG-0803-GPBP
4'	RNG-0804	RNG-0804-G	RNG-0804-GDBL	RNG-0804-GPBP



Single sided graphic

RNG-10' WIDTH				
HEIGHT	HARDWARE CODE	SINGLE-SIDED GRAPHIC CODE	DOUBLE-SIDED GRAPHIC CODE	BOTTOM ZIP-IN PANEL (PRINTED) CODE
2'	RNG-1002	RNG-1002-G	RNG-1002-GDBL	RNG-1002-GPBP
3'	RNG-1003	RNG-1003-G	RNG-1003-GDBL	RNG-1003-GPBP
4'	RNG-1004	RNG-1004-G	RNG-1004-GDBL	RNG-1004-GPBP



Double sided graphic

RNG-12' WIDTH				
HEIGHT	HARDWARE CODE	SINGLE-SIDED GRAPHIC CODE	DOUBLE-SIDED GRAPHIC CODE	BOTTOM ZIP-IN PANEL (PRINTED) CODE
2'	RNG-1202	RNG-1202-G	RNG-1202-GDBL	RNG-1202-GPBP
3'	RNG-1203	RNG-1203-G	RNG-1203-GDBL	RNG-1203-GPBP
4'	RNG-1204	RNG-1204-G	RNG-1204-GDBL	RNG-1204-GPBP



Printed zip-in bottom panel

SET UP INSTRUCTIONS:

STEP 1: TOP AND BOTTOM SHAPE ASSEMBLY

1. CONNECT ALL TUBES LINKED WITH A BUNGEE CORD.
2. CONNECT OPEN ENDED TUBES BY MATCHING NUMBERS.

STEP 2: SPREADER ATTACHMENT

1. CONNECT BOTTOM OF SPREADER TO BOTTOM SHAPE STRUCTURE WITH PUSH BUTTONS BY MATCHING LETTERS
2. CONNECT TOP OF SPREADER TO TOP SHAPE STRUCTURE WITH PUSH BUTTONS BY MATCHING LETTERS

STEP 3: GRAPHIC ATTACHMENT

1. SLIDE PILLOWCASE GRAPHIC INTO FRAME.
2. ZIP GRAPHIC CLOSED.

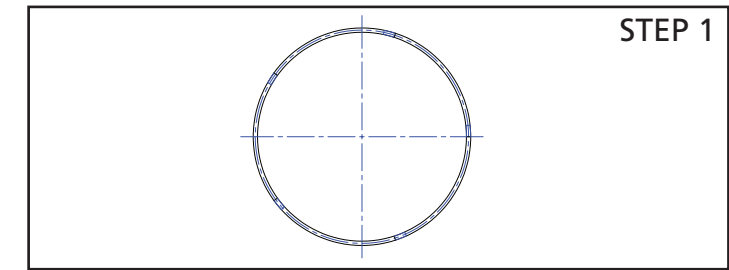
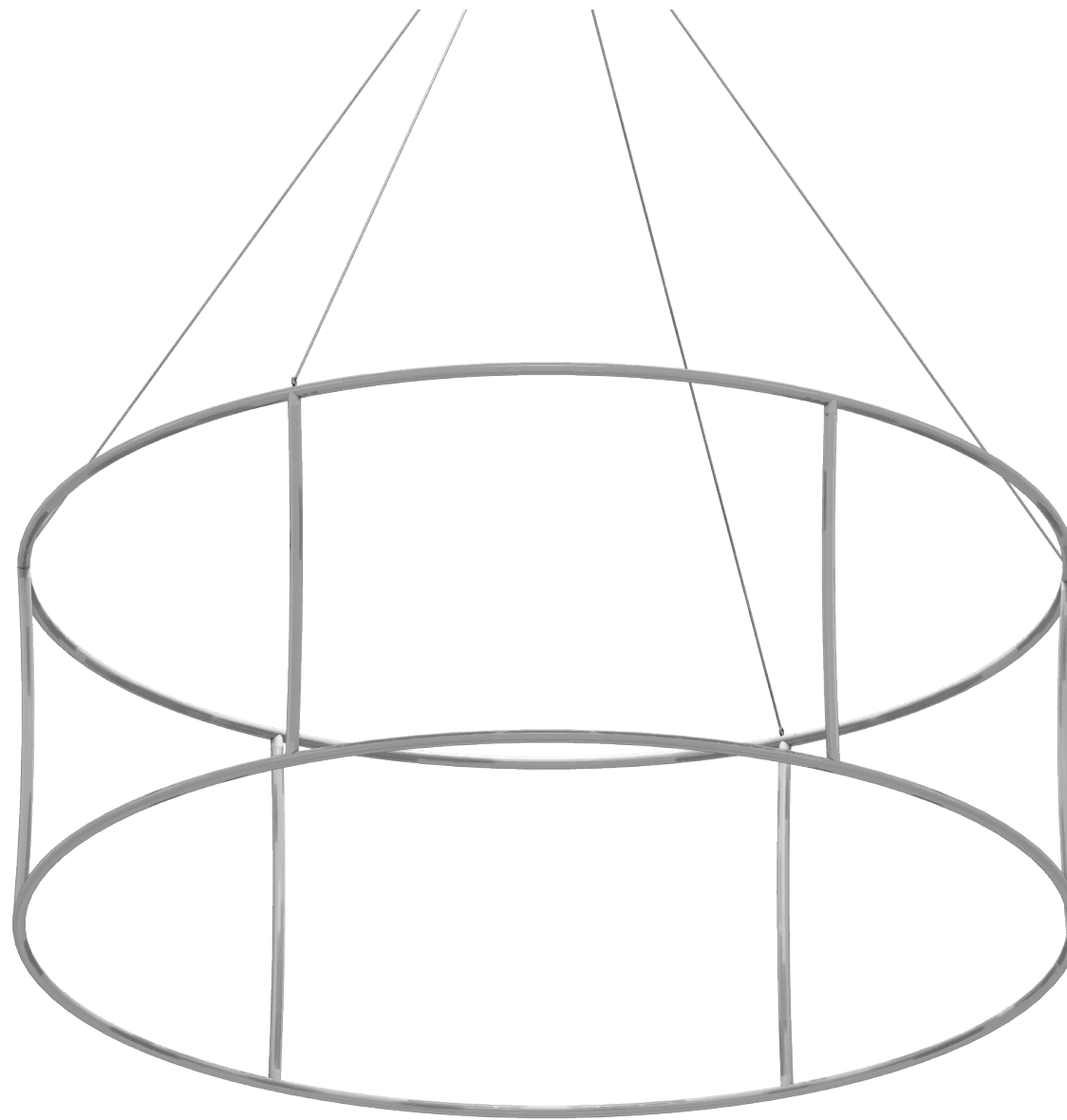

STEP 1

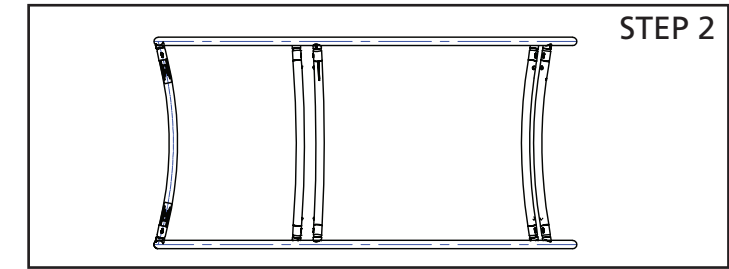

STEP 2

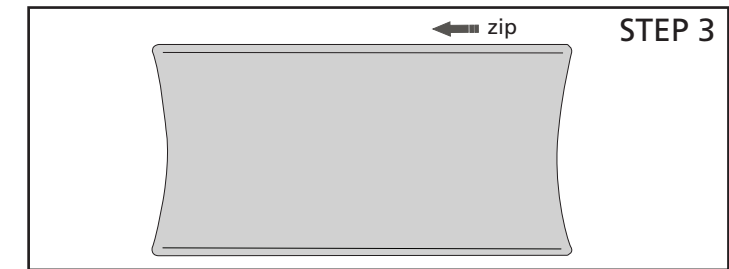

STEP 3

